

# \$30,000 - 220 Bruce Avenue, Carbon

MLS® #A2215742

**\$30,000**

0 Bedroom, 0.00 Bathroom,  
Land on 0.35 Acres

NONE, Carbon, Alberta

Showcase your business in Carbon, the Village in the Valley! A commercially zoned gravelled 15080 square foot lot in a residential area, across from the Carbon School. Carbon is a growing vibrant village with approximately 500 residents, a dramatic growth in recent years. About an hour to Calgary, under 30 mins to both Three Hills and Drumheller, and just off the highway 9 and trucking routes for easy for local business, shipping, and more .

## Essential Information

MLS® #	A2215742
Price	\$30,000
Bathrooms	0.00
Acres	0.35
Type	Land
Sub-Type	Commercial Land
Status	Active

## Community Information

Address	220 Bruce Avenue
Subdivision	NONE
City	Carbon
County	Kneehill County
Province	Alberta
Postal Code	T0M0L0

## Additional Information

Date Listed	April 28th, 2025
-------------	------------------

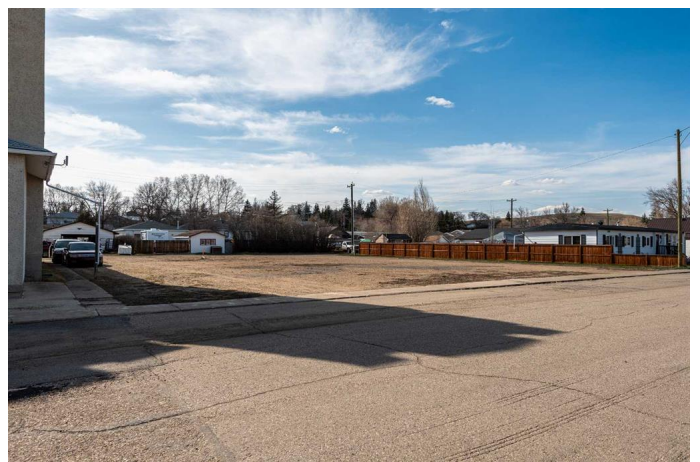

Days on Market	4
Zoning	COM

## **Listing Details**

Listing Office	Royal LePage Country Realty
----------------	-----------------------------

Data is supplied by Pillar 9â„¢ MLS® System. Pillar 9â„¢ is the owner of the copyright in its MLS® System. Data is deemed reliable but is not guaranteed accurate by Pillar 9â„¢. The trademarks MLS®, Multiple Listing Service® and the associated logos are owned by The Canadian Real Estate Association (CREA) and identify the quality of services provided by real estate professionals who are members of CREA. Used under license.