

\$75,000 - 1919 20 Avenue, Bowden

MLS® #A2219320

\$75,000

0 Bedroom, 0.00 Bathroom,
Land on 0.21 Acres

NONE, Bowden, Alberta

Prime Commercial Lot in Bowden, Alberta â€“ High-Traffic Corner Location! Unlock the potential of this exceptional vacant commercial lot situated on a busy corner in the heart of Bowden, Alberta. This high-visibility location offers maximum exposure for businesses looking to capitalize on steady traffic flow and easy accessibility. Lot Size: Approximately 78' wide x 130' deep (9,360 sqft) Strategic Corner Location â€“ Ideal for retail, service businesses, or future development. High-Traffic Area â€“ Benefit from consistent foot and vehicle traffic. Excellent Accessibility â€“ Convenient access for customers and deliveries. Whether you're looking to establish a new business, expand your portfolio, or invest in prime commercial real estate, this lot presents an unmatched opportunity in a high-demand area. Donâ€™t miss out on this rare chance to secure a premium commercial space in Bowden!

Essential Information

MLS® #	A2219320
Price	\$75,000
Bathrooms	0.00
Acres	0.21
Type	Land
Sub-Type	Commercial Land
Status	Active

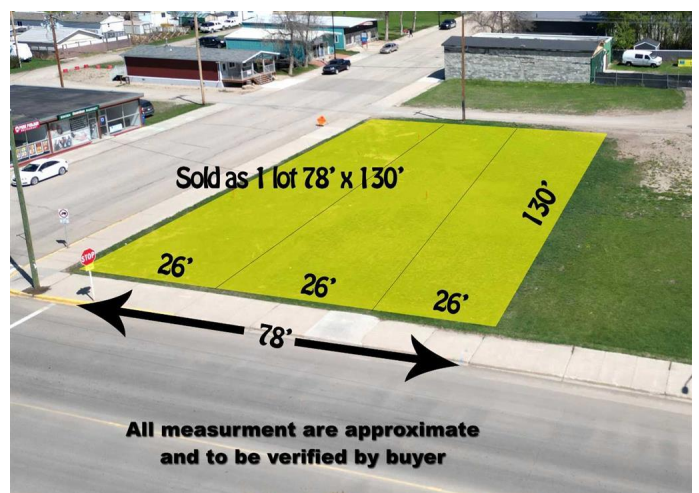

Community Information

Address	1919 20 Avenue
Subdivision	NONE
City	Bowden
County	Red Deer County
Province	Alberta
Postal Code	T0M 0K0

Exterior

Lot Description	Back Lane, City Lot, Cleared, Corner Lot, Level, Near Golf Course, Rectangular Lot
-----------------	--

Additional Information

Date Listed	May 9th, 2025
Days on Market	15
Zoning	C-1

Listing Details

Listing Office	RE/MAX real estate central alberta
----------------	------------------------------------

Data is supplied by Pillar 9â„¢ MLSÂ® System. Pillar 9â„¢ is the owner of the copyright in its MLSÂ® System. Data is deemed reliable but is not guaranteed accurate by Pillar 9â„¢. The trademarks MLSÂ®, Multiple Listing ServiceÂ® and the associated logos are owned by The Canadian Real Estate Association (CREA) and identify the quality of services provided by real estate professionals who are members of CREA. Used under license.